

SOLD



1 Taylor St Junee, Junee

Positioned in one of the most attractive Junee addresses, the magic of Hampton's shines bright in this beautifully crafted Lancaster built home on a 5295m2 block. Built in 2015, designed for a large family, you will enjoy 7 bedrooms all with built in robes plus a generous master suite with plantation shutters, WIR and modern ensuite. The living zone is impressive focused around a classic styled kitchen with stone benches. A stunning island bench for the ultimate family gathering overlooking a generous meals area. Down lights and feature lighting add a beautiful ambiance to the living zone plus your family will be sorted with a separate lounge-room.... The three way bathroom features a ...

7 2 4

Price: Undisclosed
View: <https://remaxvision.com.au/6755310>

Jenna Pollard
M 0418 421 621



Jacqui Hedlund
0416 243 257



Narrabeen

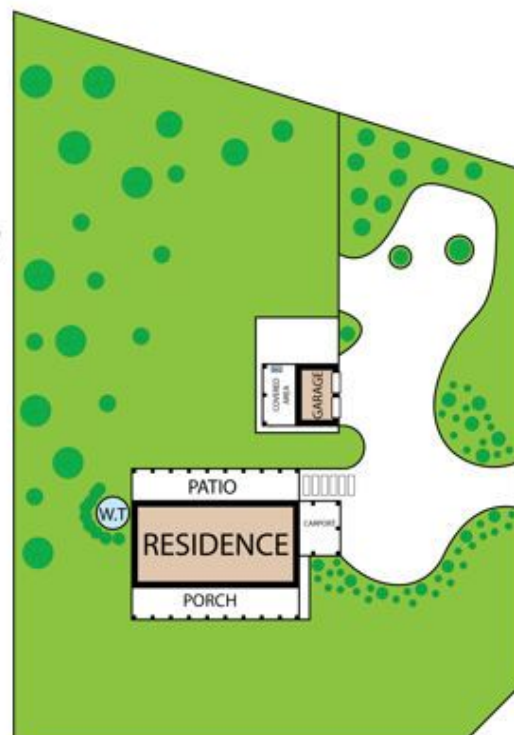
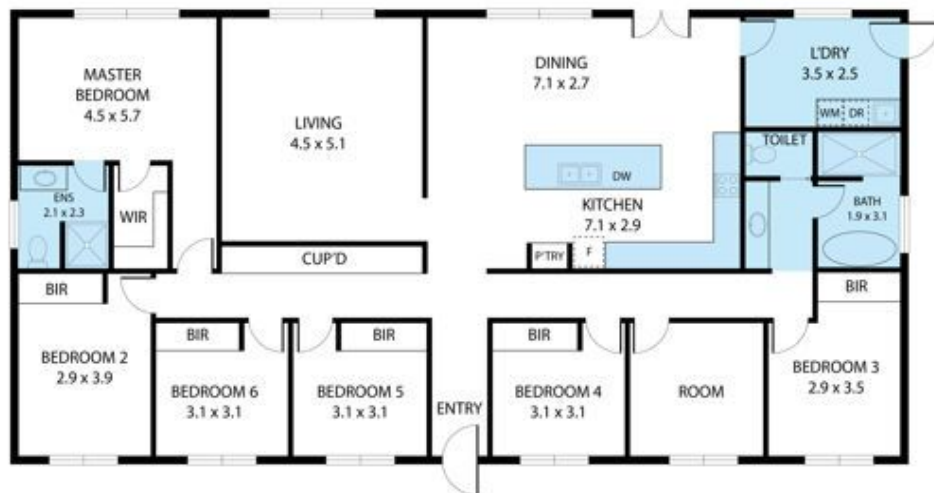

1 Taylor Street, Junee 2663

TOTAL APPROX. FLOOR AREA 193 SQ.M

Whilst every attempt has been made to ensure the accuracy of the floor plan contained here, measurements of doors, windows, rooms and any other items are approximate and no responsibility is taken for any error, omission, or misstatement. This plan is for illustrative purposes only and should be used as such by any prospective purchaser.