

FOR LEASE**3022 Byrnes Road, Junee**

Positioned as you come into Junee, this 3 bedroom, 1 bathroom property is ideal for couples, small families and downsizers.

The formal lounge room on entry flows down a central hallway with three bedrooms. Living areas and bedrooms feature lush carpet. Multiple reverse cycle split systems for comfort year round.

Kitchen features an abundance of storage and bench space with gas cooking and dishwasher with an eat in dining area. The bathroom features a combined shower and bath, vanity and separate toilet.

Enjoy a massive outdoor 4 bay car park and large enclosed back yard....

*All information contained herein is gathered from sources we believe to be reliable, however, w...

3  **1**  **4** 
Price: \$360 Weekly

View: <https://remaxvision.com.au/8021472>
Aimee Hanson
M 0418583510

 RE/MAX Property Specialits,
 Narrabeen

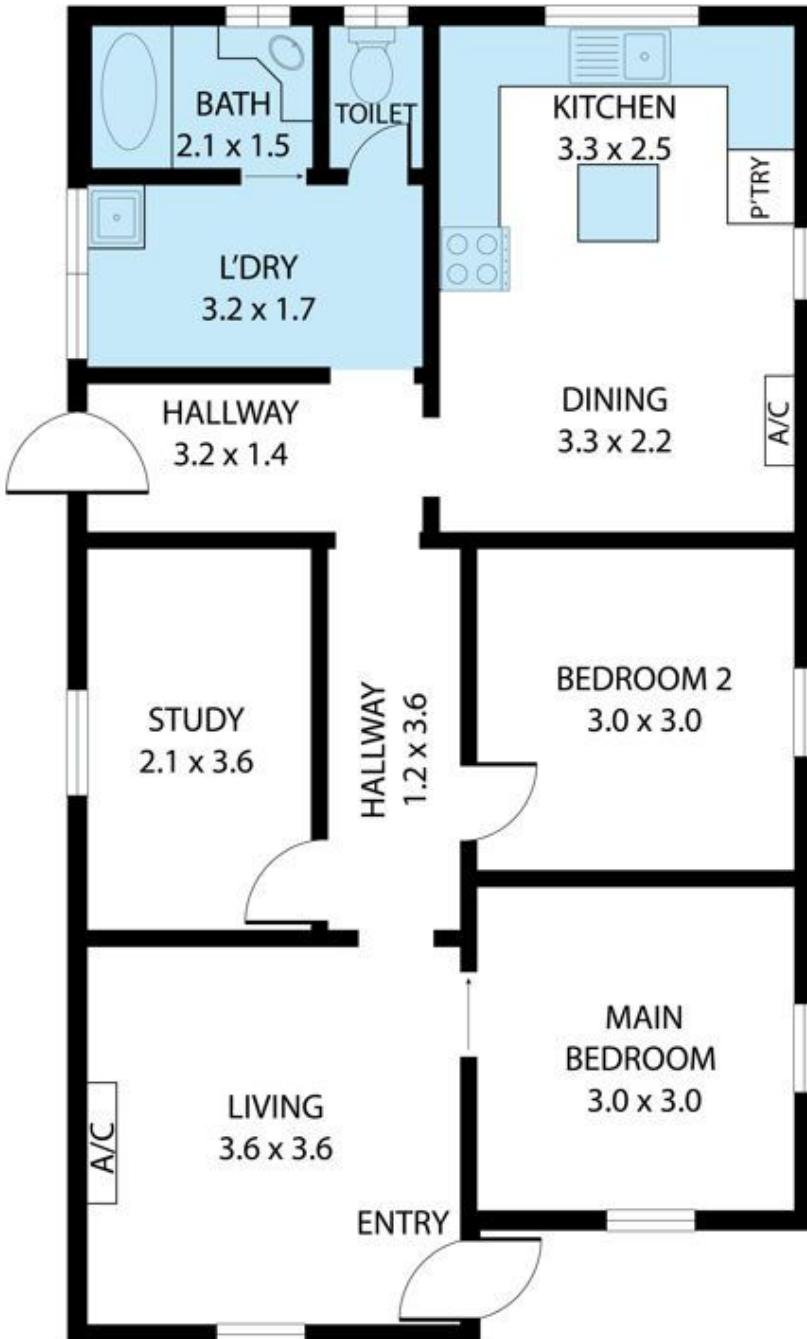

3022 Byrnes Road, Junee 2663

TOTAL APPROX. FLOOR AREA 76 SQ.M

Whilst every attempt has been made to ensure the accuracy of the floor plan contained here, measurements of doors, windows, rooms and any other items are approximate and no responsibility is taken for any error, omission, or misstatement. This plan is for illustrative purposes only and should be used as such by any prospective purchaser.